

LEVEL TWO

IMAGE NOT TO SCALE

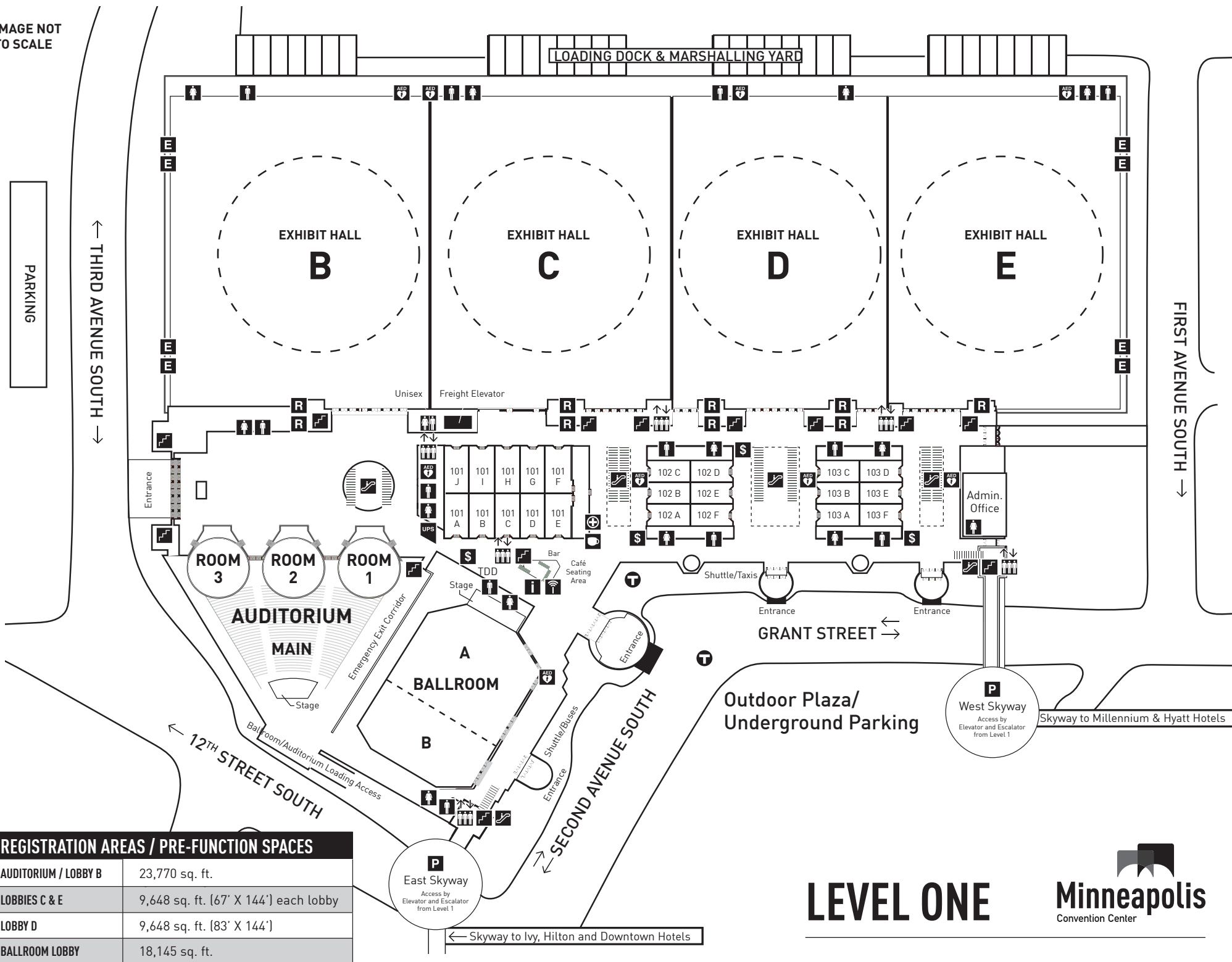

REGISTRATION AREAS / PRE-FUNCTION SPACES	
AUDITORIUM / LOBBY B	23,770 sq. ft.
LOBBIES C & E	9,648 sq. ft. (67' X 144') each lobby
LOBBY D	9,648 sq. ft. (83' X 144')
BALLROOM LOBBY	18,145 sq. ft.

LEVEL ONE



← Skyway to Ivy, Hilton and Downtown Hotels

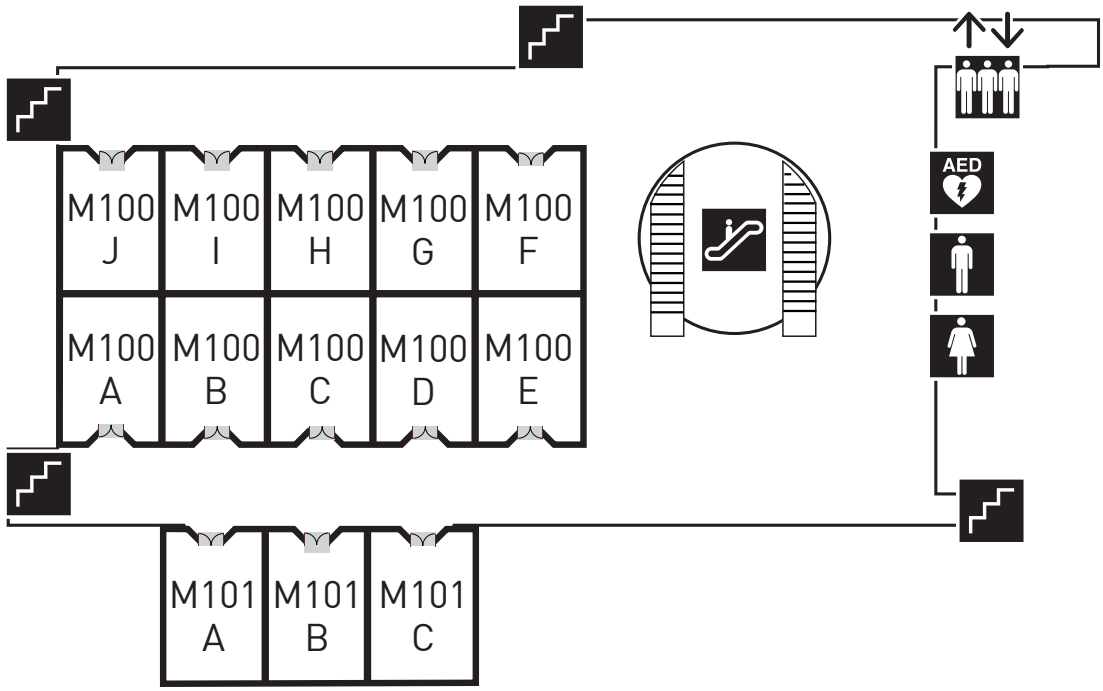

REGISTRATION AREA / PRE-FUNCTION SPACE	
MEZZANINE LOBBY	11,200 sq. ft.

MEZZANINE LEVEL



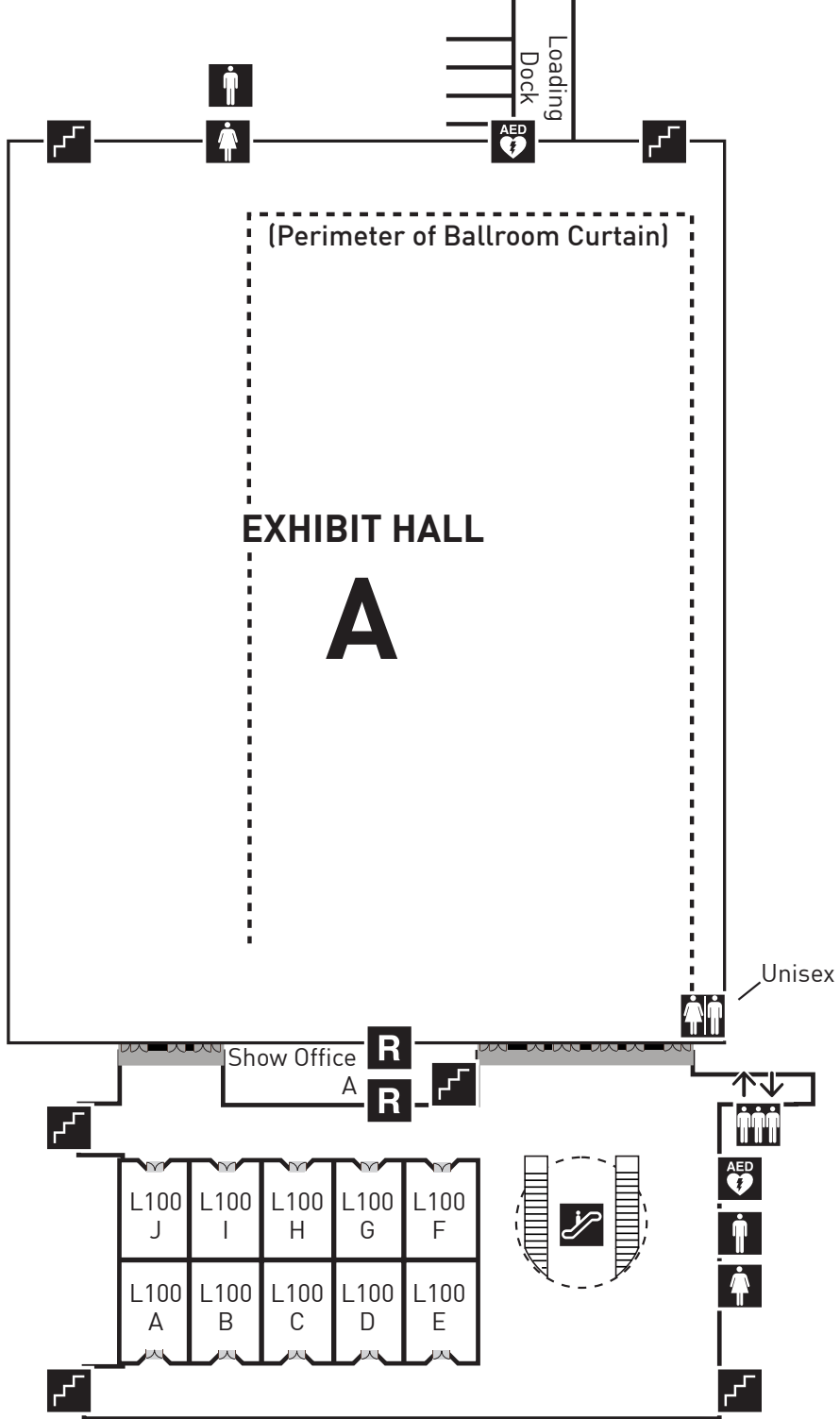

REGISTRATION AREA / PRE-FUNCTION SPACE	
LOWER LEVEL LOBBY	12,580 sq. ft.

LOWER LEVEL

